



Perfect for occasional scan, share and archive needs, the HD Ultra Office gets every **detail right for everyone in your office.**

The Contex HD Ultra brings a whole new level of amazing versatility to wide format scanning in the office. Quick, intuitive and compatible, this enhanced CCD scanner will help you save time and money by meeting your wide format scanning needs in house. In fact, when you've seen the quality and collaborative capabilities the HD Ultra for office use delivers, you won't ever want to send work out of house again.

Manage your wide format scanning in house – and save

HD Ultra Office is designed for offices that need exceptional versatility, ease of use and intuitive sharing, but also demand quality and performance day after day. With breakthrough imaging, archiving and productivity-boosting features, it gives you best-in-class image quality and the easiest and most efficient way to scan, copy, share and archive wide format images, drawings, documents and records.

Workgroup collaboration

If you need to scan wide format documents in high quality, the HD Ultra for office use is the perfect solution. Thanks to multiple output file options and SmartShare collaborative capabilities, it makes it easy and convenient for everybody to scan any wide format document, saving money on external service providers. The HD Ultra for office use is compatible with your existing software and hardware, and it's easy to use without special training. It's even network-ready, so anyone in a workgroup can use it from their own computer.

Perfect image quality

With Contex-enhanced CCD imaging, the HD Ultra for office use delivers the best image quality on the market. No matter what condition your documents are in or whether you scan maps, drawings, posters or fine art, you'll capture every document in stunning, better-than-original quality on the first try. Quality also means a reliable, energy-saving scanner that does its job without your having to think about it.

Handles any job

The HD Ultra for office use is built to handle the widest diversity of large document types, so you can be sure it will meet your needs no matter what type of document

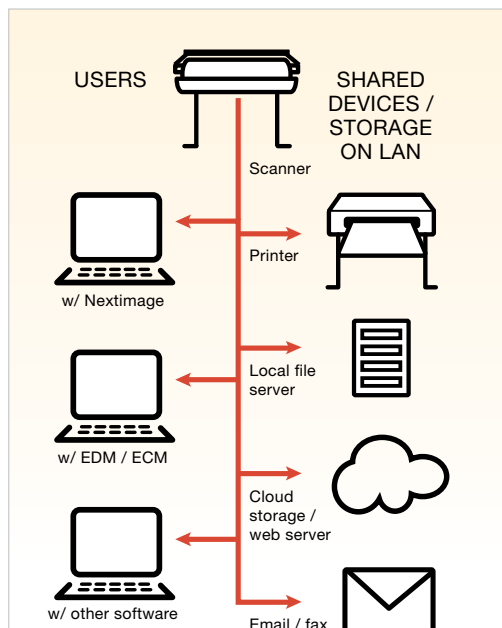

you need to scan. FlexFeed, FlexDoc and SnapSize technologies aid document handling, so that any document is easy to scan – even folded or wrinkled documents, or extra thick card. Skewed documents are dealt with automatically via software adjustments.

MFP version available

For HD Ultra Office capabilities with the same footprint as your printer, our multifunction highstand option turns your printer into a high quality copier while also saving space.

Designed in detail



Convenient right-side loading does away with the need to center and accelerates the loading process.



Gigabit Ethernet port for maximum speed and sharing flexibility.



Programmable one-touch buttons let you customize for your individual needs.



CONTEX
EMEA & AP Branch Office
Phone: +45 4814 1122
Fax: +45 4814 0122
emea-ap@contex.com

CONTEX
Americas Branch Office
Phone: +1 (703) 964 9850
Fax: +1 (703) 547 3375
salesamericas@contex.com

CONTEX
China Branch Office
Phone: +86 21 6422 2525
Fax: +86 21 5496 0724
info-china@contex.com

CONTEX
Japan Branch Office
Phone: +81 3 3669 5515
Fax: +81 3 3669 5516
info-japan@contex.com

CONTEX Head Office
Phone: +45 4814 1122
Fax: +45 4814 0122
info@contex.com

HD Ultra Office Specifications

	HD Ultra 3610	HD Ultra 3630	HD Ultra 4210	HD Ultra 4230
Scanner	600 dpi*	600 dpi*	600 dpi*	600 dpi*
Optical Resolution	o	o	o	o
1200dpi Optical Resolution	o	o	o	o
9600dpi Maximum Resolution	o	o	o	o
Maximum Scan Width	36 in. (914mm)*	36 in. (914mm)*	42in. (1067mm)	42in. (1067mm)
Maximum Media Width	44in. (1120mm)	44in. (1120mm)	44in. (1120mm)	44in. (1120mm)
Maximum Media Thickness	0.6in. (15mm)	0.6in. (15mm)	0.6in. (15mm)	0.6in. (15mm)
Accuracy	0.1% +/- 1 pixel	0.1% +/- 1 pixel	0.1% +/- 1 pixel	0.1% +/- 1 pixel
Data Capture (color/mono)	16-bit mono*	48-bit/16-bit	16-bit mono*	48-bit/16-bit
Color Space	-	sRGB	-	sRGB
USB 2.0 with xDTR	•	•	•	•
USB 2.0 + Gigabit Ethernet with xDTR2	o	o	o	o
FlexDoc	•	•	•	•
FlexFeed	•	•	•	•
SnapSize	•	•	•	•
SmartShare	•	•	•	•
ALE	•	•	•	•
AccuColor	-	•	-	•
Energy Star compliant	•	•	•	•
Software	Nextimage 30-day trial included			
Device Drivers	32 and 64-bit Windows 7, XP and Vista			
TWAIN	TWAIN driver included for use with EDM and other imaging software			
Scanning Speed*** (inch/sec.): Scanner speed while scanning 36-inch wide document.				
200dpi RGB Color	--	1.0	--	1.0
200dpi Grayscale/Monochrome	12.0	12.0	12.0	12.0
Productivity*** (documents/hour): Batch scanning for 60 minutes. Includes paper load and eject time. Measured in completed scans.				
D-size, RGB Color, 200dpi	-	175	-	175
D-size, Monochrome, 200dpi	941	941	941	941
A1-size, RGB Color, 200dpi	-	165	-	165
A1-size, Monochrome, 200dpi	901	901	901	901
Power Requirements	110/220/240V, 60/50Hz, 80W			
Weight & Dimensions LxWxH	48 kg / 52.8 x 18.7 x 7.9 inches (134 x 47.5 x 20 cm)			
Certifications/compliance	RoHS, UL, CE, GOST-R, CCC, VCCI, KETI, BSMI, ENERGY STAR compliant			

• = Included, o = Upgradable.

* Upgradable to 1200dpi/9600dpi Optical/Max Resolution. ** Upgradable to Color (1.0 ips). ***Scanning speeds depend on document width and computer configuration. For best performance, Contex recommends Intel Core Duo, Core 2 Duo, or better processors, 2GB RAM, Hi-speed USB2. Scanning speed tests performed using Nextimage software, PC with intel Core 2 Quad processor, 3GB RAM, Hi-speed USB2, 7200rpm HDD, Windows XP Pro. All trademarks remain the property of their respective holders, and are used only to directly describe the product being provided. Their use in no way indicates any relationship between Contex A/S and the holders of the said trademarks.

Designed in detail to meet your needs www.contex.com/details